

Soils Map

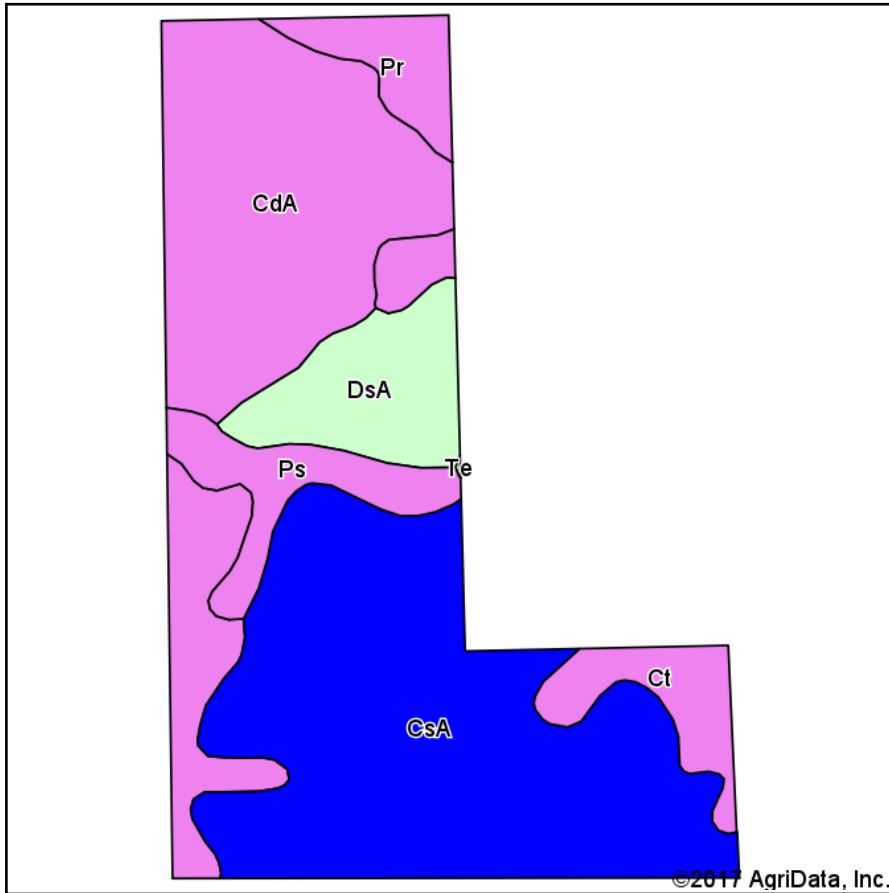

Soils data provided by USDA and NRCS.

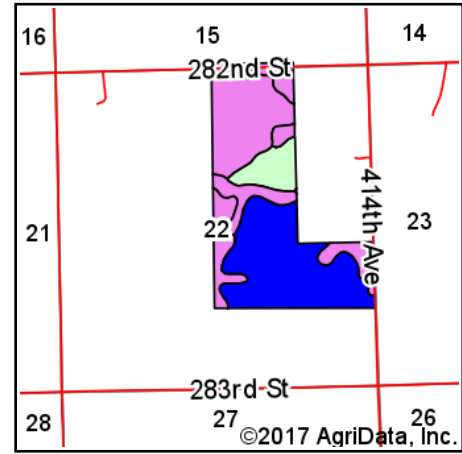





State: **South Dakota**
 County: **Hutchinson**
 Location: **23-98N-60W**
 Township: **German**
 Acres: **159.37**
 Date: **4/26/2017**

Maps Provided By:

 CUSTOMIZED ONLINE MAPPING
 © AgriData, Inc. 2017 www.AgriDataInc.com

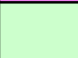
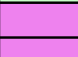

Area Symbol: SD602, Soil Area Version: 18

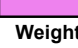
Code	Soil Description	Acres	Percent of field	PI Legend	Non-Irr Class *c	Productivity Index	Alfalfa hay	Bromegrass alfalfa	Corn	Flax	Grain sorghum	Oats	Soybeans
CsA	Houdek-Stickney complex, 0 to 2 percent slopes	67.55	42.4%		IIc	77							
CdA	Clarno-Bonilla loams, 0 to 2 percent slopes	52.78	33.1%		IIc	88							
DsA	Stickney-Dudley silt loams, 0 to 2 percent slopes	13.65	8.6%		IIIs	54							
Ps	Prosper and Crossplain complex	9.28	5.8%		IIw	85	3.5	5.8	77		67	84	30
Pr	Prosper-Stickney complex, 0 to 2 percent slopes	8.51	5.3%		IIc	85	3.5	5.8	77		67	84	30
Ct	Crossplain-Harps complex	7.60	4.8%		IIw	82	3.4	5.7	77	23	66	74	29
Weighted Average						79.8	0.6	0.9	12.3	1.1	10.6	12.9	4.7

*c: Using Capabilities Class Dominant Condition Aggregation Method

Soils data provided by USDA and NRCS.