

Soils Map

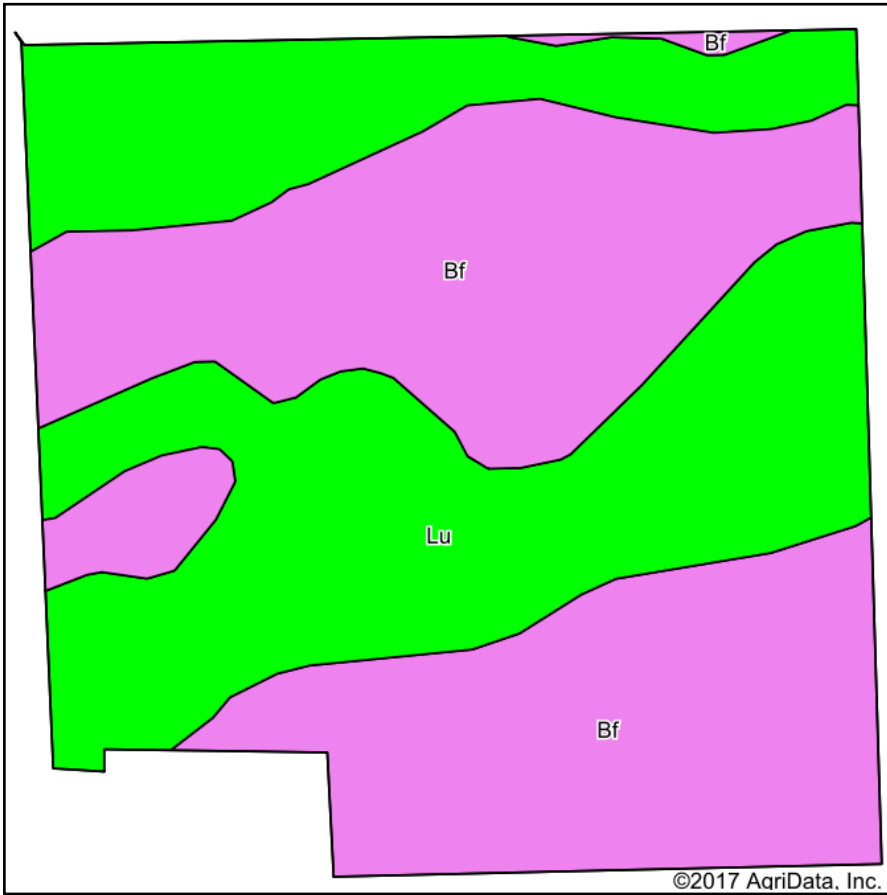

Soils data provided by USDA and NRCS.

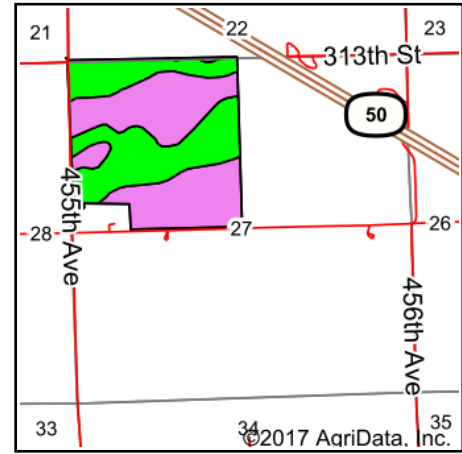

State: **South Dakota**
 County: **Clay**
 Location: **27-93N-53W**
 Township: **Meckling**
 Acres: **153.95**
 Date: **11/10/2017**

Maps Provided By:



© AgriData, Inc. 2017

www.AgriDataInc.com



Area Symbol: SD027, Soil Area Version: 19

Code	Soil Description	Acres	Percent of field	PI Legend	Non-Irr Class *c	Productivity Index	Alfalfa hay	Bromegrass alfalfa	Corn	Oats	Soybeans
Bf	Blencoe silty clay, 0 to 2 percent slopes, clayey substratum	83.24	54.1%		IIw	86	4.4	6.8	98	75	35
Lu	Luton silty clay, 0 to 2 percent slopes, rarely flooded	70.71	45.9%		IVw	60	3.4	5.5	80	44	27
Weighted Average						74.1	3.9	6.2	89.7	60.8	31.3

*c: Using Capabilities Class Dominant Condition Aggregation Method

Soils data provided by USDA and NRCS.